

# 2023 Vendor List



**THERMA-TRU**  
DOORS

## Therma-Tru®

Therma-Tru® entry door systems are the brand that most builders prefer, and they are unmatched with the best warranties in the industry. Every line of doors they offer comes with a package of performance that is unrivaled in the industry. With a front door by Therma-Tru, not only will you see an increase in comfort, energy efficiency and performance, you will also see an increase in curb appeal. Their fiberglass and steel entry doors will add beauty and security to any home.

**Product List:** Exterior Fiberglass Doors, Exterior Steel Doors, PrismaGuard® Stain, PrismaGuard® Paint, Same-Day Stain

**Reeb In-Stock Catalog Available:** <https://reeb.com/catalogs>

**Website:** <https://www.thermatru.com>



**Simpson**  
Door Company

## Simpson®

Simpson® offers more standard designs than other wood door companies. If you can't find what you're looking for in the catalogs or on the website, sketch up a door design and let their Custom Door Manufacturing Facility make it a reality. Simpson has been making doors for America's finest homes since 1912 in the forestlands of the Pacific Northwest. That's over 100 years built on product innovation and generations of employees that are passionate about what they do.

**Product List:** Exterior Wood Doors, Interior Wood Doors

**Reeb In-Stock Catalog Available:** <https://reeb.com/catalogs>

**Website:** <https://www.simpsondoor.com>



  
woodgrain doors

## Woodgrain

Woodgrain Doors is one of the world's leading manufacturers and suppliers of hardwood and softwood stile and rail doors and door components. Distributors, builders, remodelers, architects and homeowners rely on Woodgrain products to build quality homes. Woodgrain is committed to innovation through continuous improvements in manufacturing, investment in design, excellence in craftsmanship and use of the highest quality raw materials to build doors that are as durable as they are beautiful.

**Product List:** Interior Wood Doors

**Reeb In-Stock Catalog Available:** <https://reeb.com/catalogs>

**Website:** <https://www.woodgrain.com/>

**Bethlehem, PA**  
1000 Maloney Cir.  
Bethlehem, PA 18015

**Barclay, MD**  
1315 Goldsboro Rd.  
Barclay, MD 21607

**Providence, RI**  
19 Business Park Dr.  
Smithfield, RI 02917

**Syracuse, NY**  
7475 Henry Clay Blvd.  
Liverpool, NY 13088

**Mocksville, NC**  
346 Bethel Church Rd.  
Mocksville, NC 27028



## Endura™

Endura™ Products, Inc. is proud to be a U.S. American-Made manufacturer of components for entry door systems that enhance performance, save time, eliminate service calls and cut costs, delivering a smarter door experience for everyone, every time. They are built on innovation, delivering the highest levels of component performance as their standard. They pride themselves on offering solutions that lead the industry in performance and quality and are always working to make doors work not just better, but smarter.

**Product List:** FrameSaver®, Trilennium® Multi-Point Lock, Public Access Sills, Ultimate Astragal

**Website:** <https://enduraproducts.com/>



## Reeb® Finish

Reeb® Finish is a finishing solution for fiberglass doors and door units. Finishing components of a door unit separately produces much more consistent results than when finishing a pre-assembled door unit. Each step in the carefully controlled process is crucial to crafting the most authentic, longest-lasting finish possible.

**Product List:** PrismaGuard® Stain, PrismaGuard® Paint, Reeb® Finish Aluminum Clad

**Reeb In-Stock Catalog Available:** <https://reeb.com/catalogs>

**Website:** <https://reeb.com/reeb-finish>



## Steves & Sons

Steves & Sons has been serving the millwork industry for over 150 years. They manufacture interior and exterior doors and sell them to distributors who in turn sell to lumberyards, retailers and builders.

**Product List:** Interior Molded Doors, Interior Flush Doors

**Reeb In-Stock Catalog Available:** <https://reeb.com/catalogs>

**Website:** <http://www.stevesdoors.com>

**Bethlehem, PA**  
1000 Maloney Cir.  
Bethlehem, PA 18015

**Barclay, MD**  
1315 Goldsboro Rd.  
Barclay, MD 21607

**Providence, RI**  
19 Business Park Dr.  
Smithfield, RI 02917

**Syracuse, NY**  
7475 Henry Clay Blvd.  
Liverpool, NY 13088

**Mocksville, NC**  
346 Bethel Church Rd.  
Mocksville, NC 27028

# 2023 Vendor List



## DoorMerica®

The Millennium Collection consists of four distinct door products that each fit a specific demand in the world of design and construction. Infinity, Ovation, Encore and Bravo Doors are all manufactured of renewable composite wood fiber materials for stability and reliability. Their state-of-the-art design and environmentally friendly construction techniques mean endless design flexibility for your architectural design.

**Product List:** Millennium Collection® MDF Doors

**Website:** <http://www.doormerica.com>



## Larson®

For over 50 years, Larson® has brought innovations, value and quality to the storm door business. They've compromised nothing and built craftsmanship into every detail of their product. They are durable, energy efficient, stylish, innovative and most importantly a great value to you and your family. Whether you want to showcase your entry, seal a draft, let light in, or ventilate, Larson storm doors can help you add value to your home.

**Product List:** Aluminum Storm Doors

**Reeb In-Stock Catalog Available:** <https://reeb.com/catalogs>

**Website:** <https://www.larsondoors.com>



## HB&G®

HB&G® offers a wide variety of porch products to help you create the design that best suits your way of life. Best of all, many of their products require little or no maintenance and come with a lifetime guarantee. In addition to their lifetime guarantee, they are unmatched in customer care and technical support. Their highly-trained staff are waiting to answer any questions you may have. Their Architectural Department is eager to assist in custom applications as well as creating a custom product or product line to ensure you get exactly what you need.

**Product List:** Fiberglass Porch Columns, Column Caps and Bases, PVC Column Wraps, Square Columns, Wood Columns, Porch Railing, Porch Posts, Porch Ceiling Panels, Balustrade Systems, Pergolas

**Website:** <https://www.hbgcolumns.com>

**Bethlehem, PA**  
1000 Maloney Cir.  
Bethlehem, PA 18015

**Barclay, MD**  
1315 Goldsboro Rd.  
Barclay, MD 21607

**Providence, RI**  
19 Business Park Dr.  
Smithfield, RI 02917

**Syracuse, NY**  
7475 Henry Clay Blvd.  
Liverpool, NY 13088

**Mocksville, NC**  
346 Bethel Church Rd.  
Mocksville, NC 27028





**FYPON**

## Fypon<sup>®</sup>

Fypon<sup>®</sup> is the recognized leader in polyurethane product design, innovation and molding technology. From old world style to classic modern design, Fypon offers the largest and most architecturally correct styles and designs of moulding and trim, and now shutters and beams.

**Product List:** Door Trim, Window Trim, Mouldings, Decorative Millwork, Brackets, Louvers, Gable Vents, Balustrades, Shutters, Surrounds, Beams

**Reeb In-Stock Catalog Available:** <https://reeb.com/catalogs>

**Website:** <http://www.fypon.com>



**Ply Gem**<sup>®</sup>  
SHUTTERS & ACCENTS

## Ply Gem<sup>®</sup>

Headquartered in North Carolina, Ply Gem<sup>®</sup> is an industry leading manufacturer of exterior home building products; delivering nearly everything to create a custom-looking home — from siding, stone and designer accents to fence and rail, gutter protection and of course, windows.

**Product List:** Shutters

**Website:** <https://www.plygem.com/>



**Johnson**  
HARDWARE

## Johnson Hardware<sup>®</sup>

Johnson Hardware<sup>®</sup> has a complete line of superior quality sliding, folding and pocket door hardware for residential and light commercial applications. Over the years, their original designs and simple-to-install products have earned a reputation as an industry leader. All Johnson Hardware products are designed with care, built using meticulous production procedures and checked under rigid quality control standards.

**Product List:** Pocket Door Hardware, Bifold Hardware, Bypass Hardware

**Website:** <http://www.johnsonhardware.com>

**Bethlehem, PA**  
1000 Maloney Cir.  
Bethlehem, PA 18015

**Barclay, MD**  
1315 Goldsboro Rd.  
Barclay, MD 21607

**Providence, RI**  
19 Business Park Dr.  
Smithfield, RI 02917

**Syracuse, NY**  
7475 Henry Clay Blvd.  
Liverpool, NY 13088

**Mocksville, NC**  
346 Bethel Church Rd.  
Mocksville, NC 27028



**SCHLAGE**

## Schlage®

Schlage® door hardware offers an easy way to enhance the style of a home, keep it safe, and even make it smarter. Trusted in over 40 million homes, they create stylish, innovative products that bring the possibilities and potential of every door in your home to life. Which means they're opening a lot more than just doors.

**Product List:** Residential Locks

**Website:** <https://www.schlage.com>



**BALDWIN**

## Baldwin®

From being the first to forge solid brass door hardware to setting precedence for Lifetime Finishes™, Baldwin® is synonymous with innovation and unsurpassed quality. For those who aspire to make the home much more than a mere shelter Baldwin is their assurance that function and elegance, as well as lasting value and luxurious style, can be found within the same fine family of products.

**Product List:** Hinges

**Website:** <https://www.baldwinhardware.com>



**EMTEK**

## Emtek®

Emtek's products are a cut above in terms of craftsmanship and design. Emtek® has decades of experience creating door hardware. They keep their finger on the pulse of the market and regularly release new designs. Their style is current, but they never forget about the classics. From traditional to contemporary, transitional, or rustic, they have hardware to match every style.

**Product List:** Hinges

**Website:** <http://emtek.com>

**Bethlehem, PA**  
1000 Maloney Cir.  
Bethlehem, PA 18015

**Barclay, MD**  
1315 Goldsboro Rd.  
Barclay, MD 21607

**Providence, RI**  
19 Business Park Dr.  
Smithfield, RI 02917

**Syracuse, NY**  
7475 Henry Clay Blvd.  
Liverpool, NY 13088

**Mocksville, NC**  
346 Bethel Church Rd.  
Mocksville, NC 27028



## Goldberg

Goldberg Brothers, Inc. has been a manufacturer of household and industrial hardware for well over a century. Proud to be made in the USA, today the company focuses on distinctive home décor and furniture products, including award-winning Goldberg Brothers Barn Track sliding barn door hardware kits.

**Product List:** Barn Door Tracks, Barn Door Hardware

**Website:** <http://goldbergbrothers.com>



## Lambton Doors

Lambton Doors develops, manufactures and sells high-quality, value-added interior wood doors and frames of standard and ecological types for the high-end residential, commercial, architectural and institutional markets. Some of their doors and frames are certified fire-resistant up to 90 minutes. In addition it is possible to coordinate the type of veneer and the design of the frames with the doors.

**Product List:** 1-3/4" Flush Commercial Doors

**Website:** <http://www.lambtondoors.com>

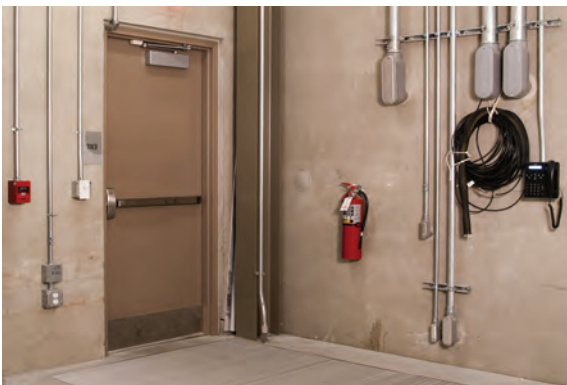

## Pioneer

Pioneer Industries is a company that has built its reputation atop three principles on which their customers can always rely: Quality. Value. Personal Attention. Their custom capability and uncompromising pledge to quality has established their brand around the world. Behind every Pioneer hollow metal door is a policy of strictly adhering the SDI standards of quality and performance, combining strength, dimensional stability and structural integrity—and all doors are still made in the USA.

**Product List:** Hollow Metal Doors

**Website:** <http://www.pioneerindustries.com>

**Bethlehem, PA**  
1000 Maloney Cir.  
Bethlehem, PA 18015

**Barclay, MD**  
1315 Goldsboro Rd.  
Barclay, MD 21607

**Providence, RI**  
19 Business Park Dr.  
Smithfield, RI 02917

**Syracuse, NY**  
7475 Henry Clay Blvd.  
Liverpool, NY 13088

**Mocksville, NC**  
346 Bethel Church Rd.  
Mocksville, NC 27028



## Commercial Accessories

To accompany our commercial doors, Reeb stocks the following accessories: locks, deadbolts, exit devices and door closers from Hager; exit devices from Precision Hardware; and lite kits from National Guard Products.

**Website:** <http://www.hagerco.com>  
<http://www.precisionhardware.com>  
<http://www.ngp.com>



## Reeb<sup>®</sup> Specialty Products

Reeb Specialty Products offers high quality products with big savings. The quality of the products provided under the RSP brand is competitive with other major brands within our industry. Reeb Specialty Products - providing value pricing on quality products.

**Product List:** Wood Doors, Fiberglass Lites, Primed Stile & Rail Doors, Hinges, Steel Edge Fire Doors, Sills, Commercial Accessories

**Website:** <https://reeb.com>



**Bethlehem, PA**  
1000 Maloney Cir.  
Bethlehem, PA 18015

**Barclay, MD**  
1315 Goldsboro Rd.  
Barclay, MD 21607

**Providence, RI**  
19 Business Park Dr.  
Smithfield, RI 02917

**Syracuse, NY**  
7475 Henry Clay Blvd.  
Liverpool, NY 13088

**Mocksville, NC**  
346 Bethel Church Rd.  
Mocksville, NC 27028